

CORNER RECORD

COUNTY OF ~~INYO~~ Mono T. 25 R. 32E MDB 4 MERIDIAN CALIFORNIA
 CORNER TYPE: GOV'T. CORNER ☐ MEANDER ☐ RANCHO ☐ CONTROL ☐ OTHER ☒
 CORNER IDENTIFICATION - DATE OF VISIT Sept. 8 1989



CORNER - LEFT AS FOUND ☒ FOUND AND TAGGED ☐ REESTABLISHED OBLITERATED CORNER ☐ REBUILT ☐

PHYSICAL DESCRIPTION OF CORNER FOUND: EVIDENCE AND METHOD USED TO IDENTIFY OR REESTABLISH Found
2' dia. rock mound, 1.0' above grd., 3650'± E. of centerline
Mono 6 @ PM 23.5 on rock & sagebrush covered slope,
2646' E. of NE-17, a USGLO br. cap on 1" ODIP.

PHYSICAL DESCRIPTION OF MONUMENTS REBUILT OR PERPETUATED

CALIFORNIA COORDINATE SYSTEM ORDER: FIRST ☐ SECOND ☐ THIRD ☒
 STATIONS USED: NGS (USC & GS) ☐ STATE ☒ COUNTY ☐ OTHER ☐ STATION PM 23.5 STATION PM 24.0
 ZONE 3 ELEVATION _____ NORTHINGS (Y) 473,346.5± EASTINGS (X) 2,591,941.5±

SKETCH: (Include reference tie or witness points, remarks and topo of area)

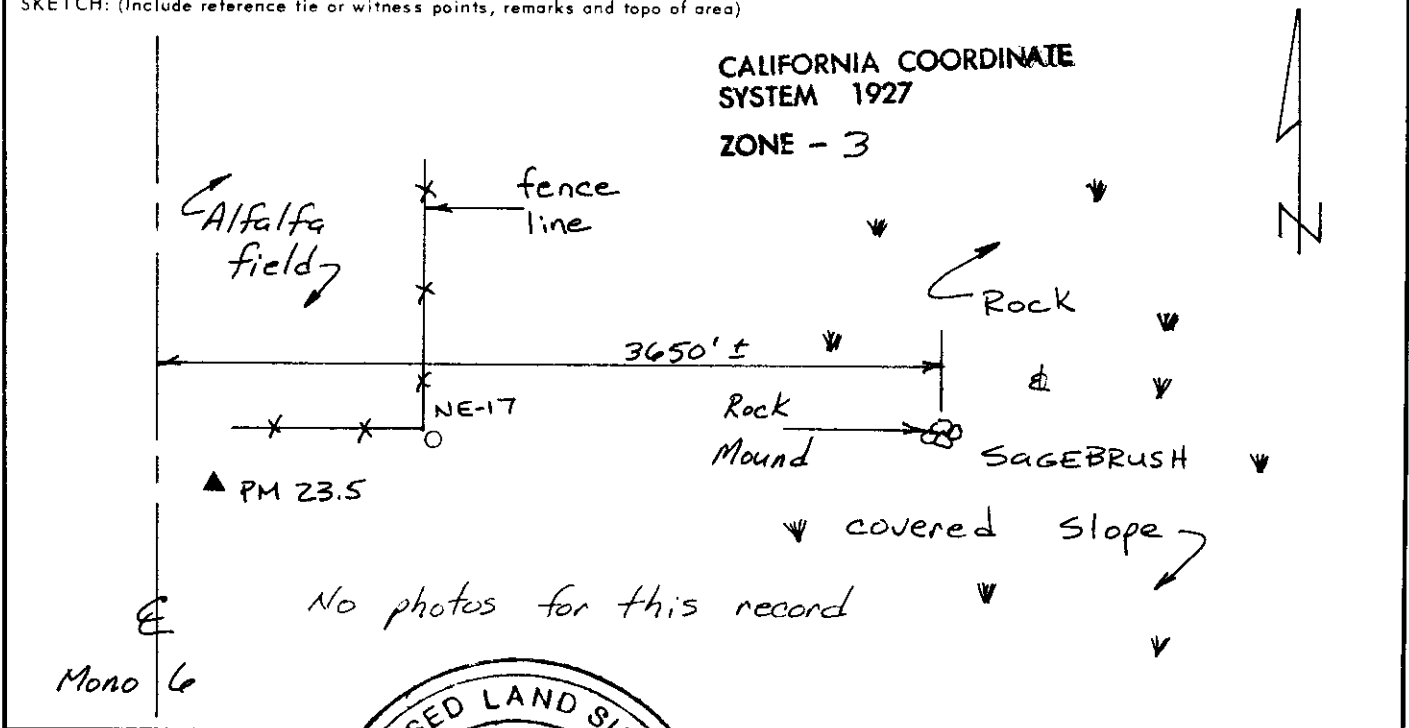

SURVEYOR'S CERTIFICATE

THIS CORNER RECORD WAS PREPARED BY ME OR UNDER MY DIRECTION IN CONFORMANCE WITH THE LAND SURVEYORS ACT ON 3/5/90 1990 NO. 4468

SIGNED: [Signature]

L.S. or R.C.E. No.: _____

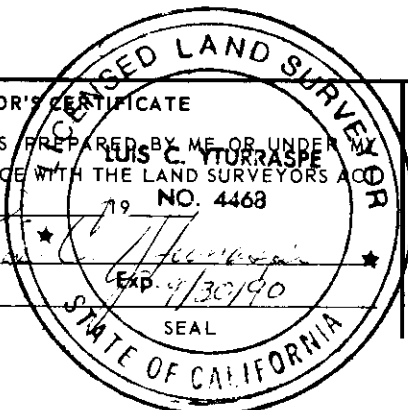

COUNTY SURVEYOR'S CERTIFICATE

THIS CORNER RECORD WAS RECEIVED 3-12 1990 AND EXAMINED AND FILED 5-4 1990

BY: [Signature]

TITLE: Mono County Surveyor

DOCUMENT No. 2532-9-2

STATEMENT ON BACK OF SHEET

YES ☐ NO ☒